

TD-9462E4B-A

6MP Dual-illumination Bullet Network Camera

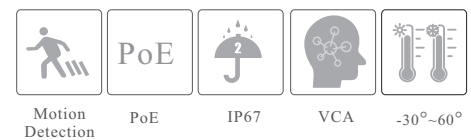

- H.265+/H.265/H.264+/H.264/MJPEG coding
- Max. resolution: 3296 × 1856
- 30~40m white light view distance; 30~50 IR view distance
- ICR auto switch, true day / night vision
- Support AI ISP
- 3D DNR, HWDR, HLC, BLC, Smart IR and ROI coding
- Support electronic image stabilization
- Built-in micro SD card slot; up to 512G
- DC12V/PoE power supply
- IP 67 ingress protection
- Support four streams
- Support NAT function
- Support SMD
- Support remote monitoring by smart phones & tablet PCs with iOS and Android OS
- Multiple smart events can be enabled at the same time
- Dual system backup

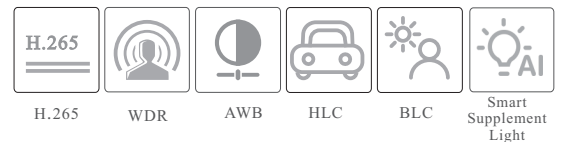

en.tvt.net.cn

For more information, please visit our website

Shenzhen TVT DIGITAL TECHNOLOGY CO., LTD.

Address: 23rd Floor, Block B4, Building NO.9, Shenzhen Bay Eco-Technology Park, Nanshan District, Shenzhen, Guangdong Province, P.R.China

Tel: +86-755-36995888

Web site: <http://en.tvt.net.cn>

Fax: +86-755-33104777

E-mail: overseas@tvt.net.cn

SPECIFICATIONS

Specifications	Model	TD-9462E4B-A		
Camera				
Image Sensor	1 / 2.4 "CMOS			
Max. Resolution	3296 × 1856			
Electronic Shutter	1 / 3s ~ 1 / 100000 s			
Iris Type	Fixed Iris	DC Iris		
Min. Illumination	0.01 lux @F1.6, AGC ON; 0 lux with illumination on			
S/N Ratio	≥50dB			
Lens	2.8 mm@F1.6, H.FoV: 104°; V.FoV: 54°; D.FoV: 125°	2.7~13.5mm@F1.6, H.FoV: 104°~3.6 mm@F1.6, H.FoV: 80°; V.FoV: 40°; D.FoV: 95°		
	3.6 mm@F1.6, H.FoV: 80°; V.FoV: 40°; D.FoV: 95°	2.7~13.5mm@F1.6, H.FoV: 104°~55°~21°; D.FoV: 124°~42°		
Focus	Fixed	Motorized		
Lens Mount	M12	Ø14		
Wide Dynamic Range	120dB			
BLC	Yes			
HLC	Yes			
Defog	Yes			
Digital NR	3D DNR			
Angle Adjustment	Pan: 0°~360°; Tilt: 0°~90°; Rotation: 0°~360°			
Image				
Video Compression	Main/Fourth stream: H.265+/H.265/H.264+/H.264 Sub/Third stream: H.265+/H.265/H.264+/H.264/ MJPEG			
H.264 Compression Standard	Baseline Profile/Main Profile/High Profile			
Resolution	6MP (3296×1856), 3K (3200×1800), 4MP(2688×1520), 2K(2560×1440), 1080P (1920×1080), 720P (1280×720), D1, VGA (640×480), 640×360, CIF, 480×240			
Main Stream	6MP/3K/4MP/2K/1080P (60Hz: 1~30fps; 50Hz: 1~25fps)			
Sub Stream	1080P(60Hz: 1~15fps; 50Hz: 1~12fps)/ 720P/D1/VGA/640×360/CIF/480×240(60Hz: 1~30fps; 50Hz: 1~25fps)			
Third Stream	720P/D1/VGA/640×360/CIF (60Hz: 1~30fps; 50Hz: 1~25fps)			
Fourth Stream	1080P/720P/D1/VGA/640×360/CIF/480×240(60Hz: 1~30fps; 50Hz: 1~25fps)			
Bit Rate	32 Kbps ~ 10 Mbps			
Bit Rate Type	VBR / CBR			
Audio Compression	G711A / U			
Image Settings	ROI, Saturation, Brightness, Hue, Contrast, Wide Dynamic, Sharpness, Image Flip, Image Mirror, NR, etc. adjustable through client software or web browser			
ROI	8 ROI, each ROI to be configured separately			
Interfaces				
Network	RJ 45 (10/100 Base-T)			
Video Output	No			
Audio	1CH audio input; 1CH audio output; 2CH built-in microphones			
Storage	Built-in micro SD card slot; up to 512G			
Reset	Yes			
Alarm	1CH alarm input; 1CH alarm output			
Intelligent Analytics				
Intelligent Video Detection (IVD)	Line crossing/ region intrusion/entrance/exiting (human/vehicle classification), loitering detection, illegal parking detection, abandoned/missing object detection, people gathering detection			
Statistics	Target counting by line/area, heat map			
Exception Detection	Scene change, video blur and abnormal color detection, audio exception			
Face Detection	Face detection and face capture			
Video Metadata	Simultaneously captures human body, motor vehicle and non-motor vehicle and extracts 13 human features, 4 motor vehicle features and 1 non-motor vehicle feature			
DORI Distance				
Lens	Detect	Observe	Recognize	Identify
2.8mm	71m(232ft)	28m(92ft)	14m(46ft)	7m(23ft)
3.6mm	99m(323ft)	40m(130ft)	20m(65ft)	10m(32ft)
2.7~13.5mm(W)	69m(227ft)	28m(92ft)	14m(45ft)	7m(23ft)
2.7~13.5mm(T)	194m(637ft)	78m(255ft)	39m(127ft)	19m(64ft)
Functions				

Remote Monitoring	Web Client/NVR/NVMS/mobile APP	
Web Browser	Chrome 105.0+/Edge 105.0+/Firefox 121.0+/Safari 14.0+	
Online Connection	Support simultaneous monitoring for up to 10 users; Support multi-stream real time transmission	
Network Protocol	UDP, IPv4, IPv6, DHCP, NTP, RTSP, RTP, RTCP, RTMP, FTP, PPPoE, DDNS, SMTP, SNMP, HTTP, 802.1x, UPnP, HTTPS, NAT, QoS, ICMP, IGMP	
Interface Protocol	ONVIF Profile S/G/M/T	
API&SDK	Yes	
Storage	Network remote storage; micro SD card storage	
Smart Alarm	Motion detection, SMD, sensor alarm, SD card error, SD card full, IP address conflict, cable disconnection, audio alarm	
General Function	Watermark, video mask, heartbeat, smart IR, smart supplement light, corridor pattern, image distortion correction, ANR, cloud upgrade, disarming	
Security	Firmware encryption, HTTPS encryption, configuration encryption, video encryption, illegal login lock, IP address filtering, 802.1x, log out after timeout basic and digest authentication for HTTP/RTSP/API service, TLS1.1/1.2/1.3	
PoE	Yes, IEEE802.3af, class3	
Supplement Light Range	IR range: 30 ~ 50 m; white light range: 30 ~ 40 m	
Ingress Protection	IP 67	
Others		
Power Supply	DC12V/PoE	
Power Consumption	DC12V: < 9.2W; PoE: < 10.9W	
Storage Conditions	- 30 °C ~ 65 °C (-22°F~149°F), Humidity: less than 95 % (non-condensing)	
Operating Conditions	- 30 °C ~ 60 °C (-22°F~140°F), Humidity: less than 95 % (non-condensing)	
Dimensions (mm)	217.8 × 80.5 × 80.3	
Weight (net)	Approx. 0.672KG	Approx. 0.686KG
Material	Aluminum alloy body	
Installation	Ceiling mounting; Wall mounting	
Certificate	CE, FCC	
Environmental Protection	Directive EU RoHS, WEEE(2012/19/EU), and REACH(EC1907/2006)	

DIMENSIONS

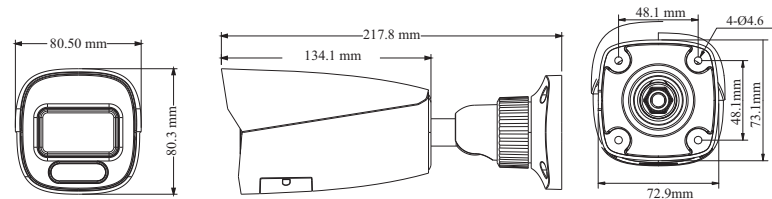

AVAILABLE ACCESSORIES



AVAILABLE MODEL

Available Model	TD-9462E4B-A(D/AZ/PE/AW3), motorized lens
	TD-9462E4B-A(D/PE/AW3), fixed lens