

CAMERA

TD-9442E3B-A

4MP IR Water-Proof Bullet Network Camera



- H.265+/H.265/H.264+/H.264/MJPEG coding
- Max. resolution: 2688 × 1520
- ICR auto switch, true day / night vision
- 30 ~ 50m IR night view distance
- 3D DNR, HWDR, HLC, BLC, Defog, Smart IR and ROI coding
- Support image distortion correction
- Built-in micro SD card slot, up to 256GB
- DC12V/PoE power supply
- IP 67 ingress protection
- Support three streams
- Support remote monitoring by smart phones & tablet PCs with iOS and Android OS
- Support SMD
- Support NAT function
- Multiple smart events can be enabled at the same time
- Dual-system backups

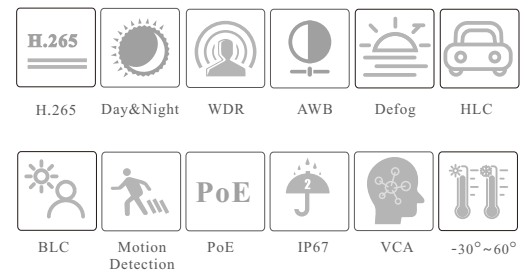

en.tvt.net.cn

For more information, please visit our website

Shenzhen TVT DIGITAL TECHNOLOGY CO., LTD.

Address: 23rd Floor, Block B4, Building NO.9, Shenzhen Bay Eco-Technology Park, Nanshan District, Shenzhen, Guangdong Province, P.R.China

Tel: +86-755-36995888

Web site: <http://en.tvt.net.cn>

Fax: +86-755-33104777

E-mail: overseas@tvt.net.cn

SPECIFICATIONS

Specifications	Model	TD-9442E3B-A		
Camera				
Image Sensor	1 / 3 "CMOS			
Image Size	2688 × 1520			
Electronic Shutter	1 / 3s ~ 1 / 100000 s			
Iris Type	Fixed Iris	DC Iris		
Min. Illumination	0.005 lux@F1.6, AGC ON; 0 lux with IR			
Lens	2.8 mm@F1.6, H.FoV: 95.3°; V.FoV: 53.2°; D.FoV: 115.0°		2.8~12mm@F1.3, H.FoV: 100.0°~28.9°; V.Fov: 54.5°~16.7°;	
	3.6 mm@F1.6, H.FoV: 78.8°; V.FoV: 42.3°; D.FoV: 100.2°		D.FoV: 118°~35°	
Focus	Fixed	Motorized		
Lens Mount	M12	Φ14		
Day & Night	ICR			
Wide Dynamic Range	120dB			
BLC	Yes			
HLC	Yes			
Defog	Yes			
S/N Ratio	≥50dB			
Digital NR	3D DNR			
Angle Adjustment	Pan: 0°~360°; Tilt: 0°~90°; Rotation: 0°~360°			
Image				
Video Compression	Main stream: H.265+ / H.265 / H.264+ / H.264 Sub/Third stream: H.265+ / H.265 / H.264+ / H.264 / MJPEG			
H.264 Compression Standard	Baseline Profile/Main Profile/High Profile			
Resolution	4MP (2688×1520), 2592×1520, 2K (2560×1440), 3MP(2304×1296), 1080P (1920×1080), 720P (1280×720), D1, VGA(640×480), 640×360, CIF, 480×240			
Main Stream	4MP/2592×1520/2K/3MP/1080P (60Hz: 1~30fps; 50Hz: 1~25fps)			
Sub Stream	1080P (60Hz:1~15fps; 50Hz:1~12fps)/ 720P/D1/VGA/640×360/480×240/CIF(60Hz: 1~30fps; 50Hz: 1~25fps)			
Third Stream	720P/D1/CIF/480×240 (60Hz: 1~30fps; 50Hz: 1~25fps)			
Bit Rate	64 Kbps ~ 8 Mbps			
Bit Rate Type	VBR / CBR			
Audio Compression	G711A / U			
Image Settings	ROI, Saturation, Brightness, Hue, Contrast, Wide Dynamic, Sharpness, Image Mirror, Image Flip, NR, etc. adjustable through client software or web browser			
ROI	Each ROI to be configured separately			
Interfaces				
Network	RJ 45 (10/100 Base-T)			
Video Output	No			
Audio	1CH audio input; 1CH audio output; 1 CH built-in MIC			
Storage	Built-in micro SD card slot; up to 256GB			
Reset	Yes			
Alarm	1CH alarm input; 1CH alarm output			
Intelligent Analytics				
Intelligent Video Detection (IVD)	Line crossing, region intrusion/entrance/exiting (human/vehicle classification) loitering detection, illegal parking detection, abandoned/ missing object detection			
Statistics	Target counting by line/area, heat map			
Exception Detection	Scene change, video blur and video cast detection, audio exception			
Face Detection	Face detection and face capture			
Video Metadata	Simultaneously captures human body, motor vehicle and non-motor vehicle and extracts 13 human features, 4 motor vehicle features and 1 non-motor vehicle feature			
DORI Distance				
Lens	Detect	Observe	Recognize	Identify
2.8mm	60m(199ft)	24m(79ft)	12m(39ft)	6m(19ft)
3.6mm	75m(246ft)	30m(98ft)	15m(49ft)	7m(24ft)
2.8~12mm(W)	58m(193ft)	23m(77ft)	11m(38ft)	5m(19ft)
2.8~12mm(T)	205m(675ft)	82m(270ft)	41m(135ft)	20m(67ft)
Functions				
Remote Monitoring	Web Browser/NVMS/NVR/mobile APP			

Web Browser	Chrome 105.0+/Edge 105.0+/Firefox 121.0+/Safari 14.0+	
Online Connection	Support simultaneous monitoring for up to 8 users; Support multi-stream real time transmission	
Network Protocol	UDP, IPv4, IPv6, DHCP, NTP, RTSP, RTP, RTMP, RTCP, PPPoE, DDNS, SMTP, FTP, SNMP, HTTP, 802.1x, UPnP, HTTPS, NAT, QoS	
Interface Protocol	ONVIF	
API&SDK	Yes	
Storage	Network remote storage; micro SD card storage	
Smart Alarm	Motion detection, SMD, SD card error, SD card full, IP address conflict, network disconnection, sensor alarm, audio alarm	
General Function	Watermark, video mask, heartbeat, image distortion correction, corridor pattern, disarming, ANR, cloud upgrade	
Security	Video encryption, firmware encryption, HTTPS encryption, configuration encryption, illegal login lock, IP address filtering, 802.1x authentication, basic and digest authentication for HTTP/RTSP/API	
PoE	Yes, IEEE802.3af	
IR Distance	30 ~ 50 m	
Ingress Protection	IP 67	
Others		
Power Supply	DC12V/PoE	
Power Consumption	DC12V: <9W; PoE: <10.7W	
Storage Conditions	- 30 °C ~ 65 °C (-22°F~149°F), Humidity: less than 95 % (non-condensing)	
Operating Conditions	- 30 °C ~ 60 °C (-22°F~140°F), Humidity: less than 95 % (non-condensing)	
Dimensions (mm)	217.6 × 80.5 × 80.3	
Weight (net)	Approx. 0.67KG	Approx. 0.696KG
Material	Aluminum alloy body	
Installation	Ceiling mounting; Wall mounting	
Certificate	CE, FCC	
Environmental Protection	Directive EU RoHS, WEEE(2012/19/EU), and REACH(EC1907/2006)	

DIMENSIONS

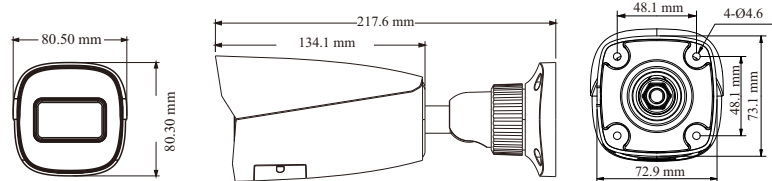

AVAILABLE ACCESSORIES



AVAILABLE MODEL

Available Model	TD-9442E3B-A(D/PE/AR3)	Fixed lens
	TD-9442E3B-A(D/AZ/PE/AR3)	Motorized zoom lens