

CAMERA

TD-9482E3B-A

8MP HD AI Bullet Network Camera



- H.265+/H.265/H.264+/H.264/MJPEG coding
- Max.resolution: 8MP (3840 × 2160)
- ICR auto switch, true day / night vision
- 3D DNR, HWDR, HLC, BLC and ROI coding
- Support electronic image stabilization
- 30~50m IR night view distance
- 1CH audio input
- Built-in micro SD card slot, up to 512GB
- DC12V/PoE power supply
- Support three streams
- IP 67
- Support mobile surveillance by smart phones with iOS and Android OS
- Support SMD
- Multiple smart events can be enabled at the same time
- Support NAT function
- Support dual-system backup

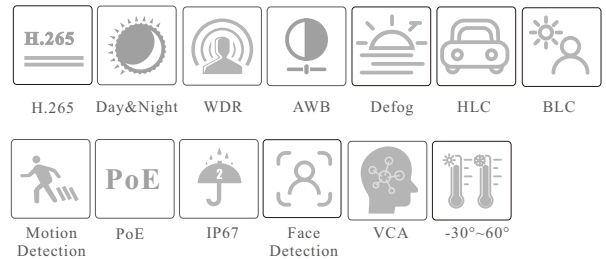

en.tvt.net.cn

For more information, please visit our website

Shenzhen TVT DIGITAL TECHNOLOGY CO., LTD.

Address: 23rd Floor, Block B4, Building NO.9, Shenzhen Bay Eco-Technology Park, Nanshan District, Shenzhen, Guangdong Province, P.R.China

Tel: +86-755-36995888

Web site: <http://en.tvt.net.cn>

Fax: +86-755-33104777

E-mail: overseas@tvt.net.cn

SPECIFICATIONS

Specifications	Model	TD-9482E3B-A		
Camera				
Image Sensor		1 / 2.8 "CMOS		
Image Size		3840×2160		
Electronic Shutter		1 / 3 s ~ 1 / 1000000 s		
Iris Type		Fixed Iris		
Min. Illumination		0.02 lux@F1.6, AGC ON; 0 lux with IR		
Lens		2.8mm@F1.6, Horizontal FoV:104°;Vertical FoV:55°;Diagonal FoV:125°		
Focus		Fixed		
Lens Mount		M12		
Day & Night		ICR		
Wide Dynamic Range		120dB		
BLC		Yes		
HLC		Yes		
Defog		Yes		
S/N Ratio		≥50dB		
Digital NR		3D DNR		
EIS		Yes		
Angle Adjustment		Pan: 0°~360°; Tilt:0°~90°; Rotation: 0°~360°		
Image				
Video Compression		Main stream: H.265+ / H.265 / H.264+ / H.264 Sub stream: H.265+ / H.265 / H.264+ / H.264 / MJPEG Third stream: H.265+ / H.265 / H.264+ / H.264 / MJPEG		
H.264 Compression Standard		Baseline Profile/Main Profile/High Profile		
Resolution		8MP(3840×2160), 6MP(3200×1800), 4MP(2688×1520), 2K(2560×1440), 1080P(1920×1080), 720P(1280×720), VGA(640×480), 640×360, 480×240, D1, CIF		
Main Stream		8MP/6MP/4MP/2K/1080P(60Hz: 1~30fps; 50Hz: 1~25fps)		
Sub Stream		1080P/720P/D1/VGA/640×360/480×240/CIF(60Hz: 1~30fps; 50Hz: 1~25fps)		
Third Stream		720P(1~15fps)/D1/640×360/VGA/CIF/480×240(60Hz: 1~30fps; 50Hz: 1~25fps)		
Bit Rate		64 Kbps ~ 12Mbps		
Bit Rate Type		VBR / CBR		
Audio Compression		G711A / U		
Image Settings		ROI, Saturation, Brightness, Hue, Contrast, Wide Dynamic, Sharpness, Image Mirror, Image Flip, NR, etc. adjustable through client software or web browser		
ROI		Each ROI to be configured separately		
Interfaces				
Network		RJ 45 (10/100 Base-T)		
Video Output		No		
Audio		1CH audio input		
Storage		Built-in micro SD card slot; up to 512GB		
Reset		Yes		
Alarm		No		
Intelligent Analytics				
Intelligent Video Detection (IVD)		Line crossing, region intrusion/entrance/exiting (human/vehicle classification), loitering detection, illegal parking detection, abandoned/missing object detection		
Statistics		Target counting by line/area, heat map		
Exception Detection		Scene change, video blur and abnormal color detection, audio exception		
Face Detection		Face detection and face capture		
Video Metadata		Simultaneously captures human body, motor vehicle and non-motor vehicle and extracts 13 human features, 4 motor vehicle features and 1 non-motor vehicle feature		
DORI Distance				
Lens	Detect	Observe	Recognize	Identify
2.8mm	83m(272ft)	33m(108ft)	17m(56ft)	8m(26ft)
Functions				
Remote Monitoring		Web Browser/TVT NVMS2.0/NVR/mobile APP		
Web Browser		Chrome 105.0+/Edge 105.0+/Firefox 121.0+/Safari 14.0+		
Online Connection		Support simultaneous monitoring for up to 10 users; Support multi-stream real time transmission		

Network Protocol	UDP, IPv4, IPv6, DHCP, NTP, RTSP, RTP, RTMP, RTCP, PPPoE, DDNS, SMTP, FTP, SNMP, HTTP, 802.1x, UPnP, HTTPS, NAT, QoS
Interface Protocol	ONVIF
API & SDK	Yes
Storage	Network remote storage; micro SD card storage
Smart Alarm	Motion detection, SMD, SD card error, SD card full, IP address conflict, Network disconnection, sensor alarm
General Function	Watermark, video mask, heartbeat, image distortion correction, corridor pattern, ANR, cloud upgrade, disarming
Security	Video encryption, firmware encryption, HTTPS encryption, configuration encryption, illegal login lock, IP address filtering, 802.1x authentication, basic and digest authentication for HTTP/RTSP/API
PoE	Yes, IEEE802.3af
IR Distance	30 ~50 m
Ingress Protection	IP67
Others	
Power Supply	DC12V/PoE
Power Consumption	PoE: max. 8.4W; DC12V: max. 7.4W
Storage Conditions	- 30 °C ~ 65 °C (-22°F~149°F), Humidity: less than 95 % (non-condensing)
Operating Conditions	- 30 °C ~ 60 °C (-22°F~140°F), Humidity: less than 95 % (non-condensing)
Dimensions (mm)	217.6 × 80.5 × 80.3
Weight (net)	Approx. 0.68KG
Material	Aluminum alloy body
Installation	Ceiling mounting; Wall mounting
Certificate	CE, FCC
Environmental Protection	Directive EU RoHS, WEEE(2012/19/EU), and REACH(EC1907/2006)

DIMENSIONS

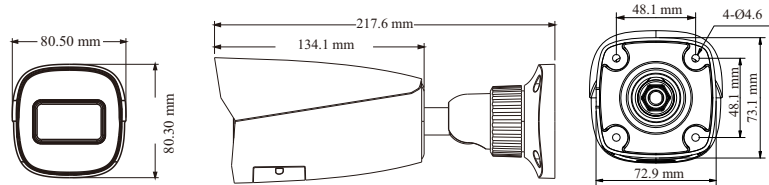

AVAILABLE ACCESSORIES



AVAILABLE MODEL

Available Model	TD-9482E3B-A(D/PE/AR3)
-----------------	------------------------